



2000 I-30 E
Greenville, TX 75402

Monday, November 7, 2022

Office of Hopkins County Judge
PO Box 288
Sulphur Springs TX 75483

Farmers Electric Cooperative Member: PATRICK COVINGTON
Service Order Number: 2022102641

Greetings:

Farmers Electric Cooperative, Inc. is requesting permission to construct electrical power distribution facilities which will cross County Road 1131 which is located 1555 ft north of FR 1567 W in Hopkins County, Texas.

Site location map and construction sketches are enclosed. The construction sketch details the proposed work. All road crossings will have a minimum vertical clearance of 22 feet.

If you have any questions, please contact me at any time.

Sincerely,

Thomas Dennis

Project Coordinator
tdennis@farmerselectric.coop
Phone 903-513-2537

Submitted by Brandon Darrow
bdarrow@farmerselectric.coop
Field Engineering Coordinator

Enclosures

County Approval Section:

Approved: Denied:

Authorized Signature: *Melroy Barker* Date: 10/7/22

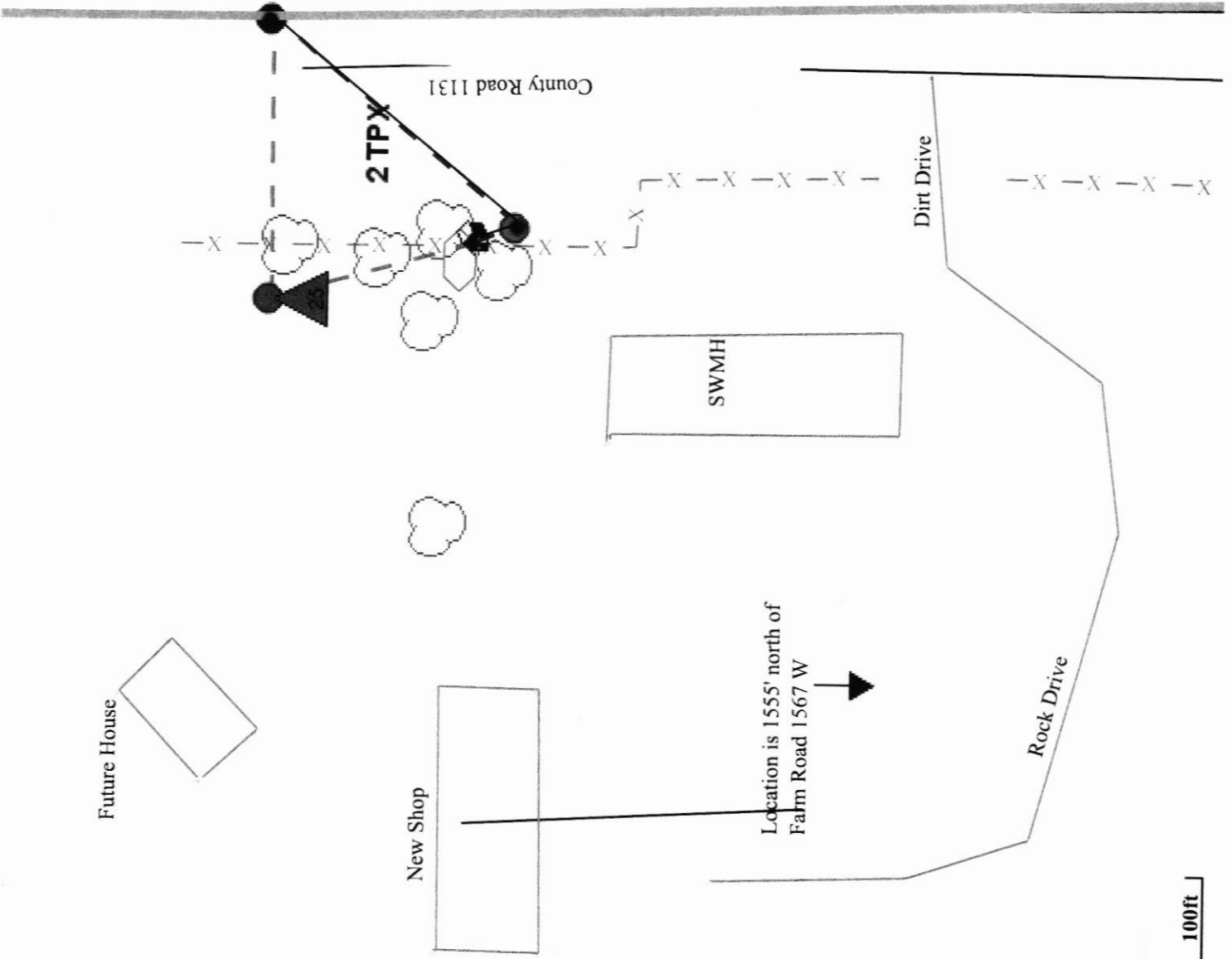

100ft

Patrick Covington
Service Order#
2022102641
Change angle of service
wire crossing CR 1131 at
Pole# 002226.

